

Electromagnetic Door Holders

Data Sheet



Notifier by Honeywell's range of door retainers provides attractive aesthetics and high performance for fire alarm systems requiring electromagnetic door retainers.

Each door retainer is fitted with a spring loaded release pin mounted centrally within the electromagnet. On power off, the release pin then pushes the door away from the electromagnet. This overcomes any residual magnetism ensuring correct operation.

The D.C. unit is fitted with a suppression diode and protection against reverse polarity such that it may be operated from a reverse polarity monitored circuit.

The low profile, flame retardant ABS housing results in an attractive and robust design and contains a push button for quick, easy release of the door.

Key Features

- Low profile design
- 200N holding force
- Easy cable entry & exit
- A.C. or D.C. options
- Push button release/test
- Floor mounting bracket available
- Anti-residual magnetism feature
- D.C. version polarised and suppressed
- EN1155 :1997 (CPD Approved)

DR/W Door Holders

To close fire doors in an emergency and prevent the spread of fire and smoke. Both door holders are fitted with an integral manual release button, allowing the door to be closed without operating the fire alarm. Both versions are supplied with a door mounting keeper plate.

EN1155 :1997 (CPD Approved)



Specifications

Floor Mounted 24V dc door holder - 04390-41

Mechanical Specification

- Approx Weight 700g
- Finish White painted housing, zinc plated magnet
- Holding Force 200N

Electrical Specification

- Voltage 24V dc
- Current Consumption 45mA

Approvals

- NA

Environmental Specifications

- Ambient Temperature 0°C to +35°C

Wall Mounted 24V dc door holder - 04390-31

Mechanical Specification

- Approx Weight 360g
- Finish White Fire Resistant ABS
- Holding Force 200N

Electrical Specification

- Voltage 24V dc
- Current Consumption 50mA

Approvals

- EN1155 :1997 (CPD Approved)

Environmental Specifications

- Ambient Temperature 0°C to +40°C

Wall Mounted 230V ac door holder - 04390-55

Mechanical Specification

- Approx Weight 360g
- Finish White Fire Resistant ABS
- Holding Force 200N

Electrical Specification

- Voltage 230V ac
- Current Consumption 12mA

Approvals





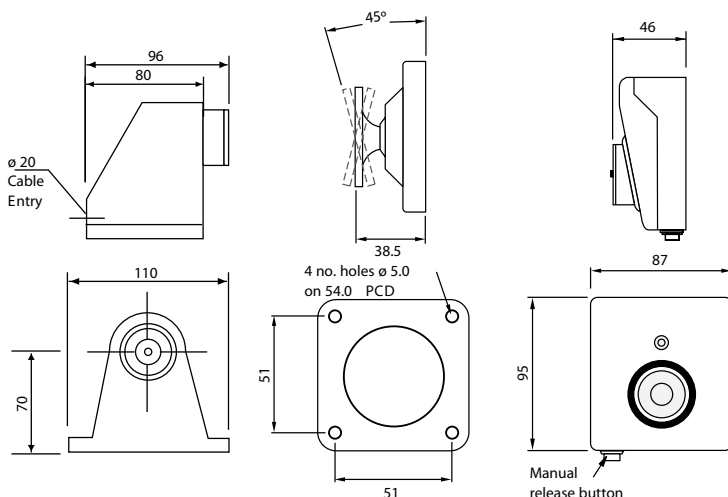

- EN1155 :1997 (CPD Approved)

Environmental Specifications

- Ambient Temperature 0°C to +40°C



Product Range at a Glance

		Part Number
	Magnet Door Holder 24V DC 22mA	04390-31
	Magnet Door Holder floor mounted 24V DC 45mA	04390-41
	Magnet Door Holder 240V AC 17.5mA	04390-55
	Door Holder Floor Plate; fixing door holder at right angle to floor	04390-92
	Door Plate Assembly (Spare), Door Keeper Plate in two pieces	04390-99
	Door Hold Transformer-Rectifier 24V 2A	HLS-PSU-TR20
	Door Hold Transformer-Rectifier 24V 4A	HLS-PSU-TR40



Charles Avenue | T: +44 (0) 116 246 2255
Burgess Hill | F: +44 (0) 116 246 2210
W. Sussex | E: sales@notifierfiresystems.co.uk
RH15 9UF | www.notifierfiresystems.co.uk